



**Earthquake Engineering  
Research Institute**

## 2009 EERI Annual Graphics Competition

*Innovative Thinking . Effective Presentation*

Organized by the Younger Members Committee, the Annual Graphics Competition is intended to encourage innovative thinking in earthquake-related research and to promote a sense of participation and competition in a multidisciplinary environment.

The competition is held once a year. A team of judges will review the works anonymously, and the finalists will be announced during the Awards Luncheon at the EERI Annual Meeting. Judges are nominated by the votes of the Younger Members Committee and approved by the Board of Directors.

A maximum of three submissions per person will be accepted from EERI members. The competition is juried by seven top earthquake professionals from different disciplines. The submission process is entirely electronic. Examples of artwork include but are not limited to pictures, design graphs, mathematical concepts and formulae in graphical formats, logos, computer animations and simulations, and conceptual design. Submitted artwork must be related to earthquake science and engineering, earthquake causes, and consequences of earthquakes.

### Deadline

August 31, 2009

### Award Ceremony

Will be held during the Awards Luncheon at the EERI 2010 Annual Meeting.

*The graphics to the right were among those submitted to the 2008 competition. The top image is from the winning entry, a four-minute animation of a retrofit design from Tipping Mar + Associates. To view the top three submissions, visit <http://www.eeri.org/site/content/view/528/72/>.*

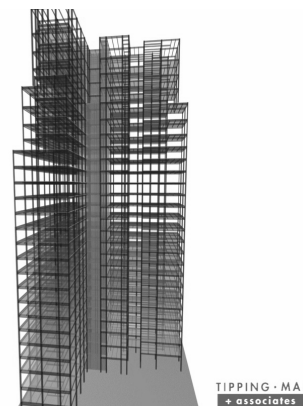

*Steven B. Tipping, et al.*

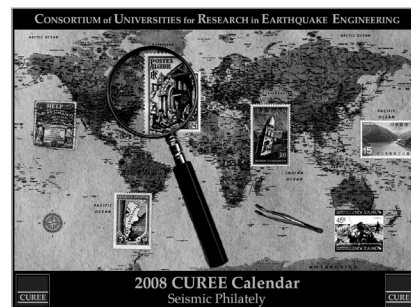

*David J. Leeds, Bob Reitherman,  
and CUREE*

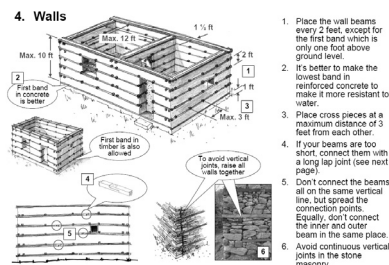

*Tom Schacher*

## **Reasons to Enter**

Promote your work within the Institute and gain recognition among your colleagues!

The finalists will be announced during the EERI Annual Meeting. The top winner will also be featured in the *EERI Newsletter* and will receive a plaque of recognition. The winning graphics may be considered for use in EERI publications or multimedia products, with appropriate acknowledgment.

All finalists will be mentioned in the *EERI Newsletter*.

## **Submission Process**

Submissions are electronic. Entries must be accompanied by a maximum 100-word description of the artwork. If your file size is 8 MB or less, please e-mail it to [graphics@eeri.org](mailto:graphics@eeri.org) before the due date. Larger files – up to a maximum of 250 MB -- should be submitted on CD or DVD to:

EERI  
c/o 2009 Annual Graphics Competition  
499 14th Street, Suite 320  
Oakland, CA 94612

## **Rules**

### *Selection of the Jury Members*

Nominated by the EERI Younger Members Committee and endorsed by the Board of Directors.

### *Administration*

The competition is administered by the Younger Members Committee of EERI.

### *Examination*

Two rounds of examinations: first a 5-grade ranking system for the finalists and then selection of the top winner.

### *Judging Criteria*

Design Quality, Conceptual Strength, Originality and Artistic Presentation, Relevance and Significance.

## **Categories**

Drawing and Painting, Graphs and Diagrams, Symbols and Mathematics, Maps, Photography, Engineering Drawings, Computer Graphics, Web Graphics, Moving Pictures, Lecture Slides, and Presentation Graphics.